

HETERO JUNCTION FIELD EFFECT TRANSISTOR NE4210S01

X to Ku BAND SUPER LOW NOISE AMPLIFIER N-CHANNEL HJ-FET

DESCRIPTION

The NE4210S01 is a Hetero Junction FET that utilizes the hetero junction to create high mobility electrons. Its excellent low noise and associated gain make it suitable for DBS and another commercial systems.

FEATURES

- Super Low Noise Figure & High Associated Gain
NF = 0.5 dB TYP. Ga = 13.0 dB TYP. @f = 12 GHz
- Gate Length: $L_g \leq 0.20 \mu\text{m}$
- Gate Width : $W_g = 160 \mu\text{m}$

ORDERING INFORMATION (PLAN)

Part Number	Marking	Supplying Form
NE4210S01-T1	L	Tape & reel 1 kp/reel
NE4210S01-T1B		Tape & reel 4 kp/reel

Remark To order evaluation samples, please contact your local NEC sales office. (Part number for sample order: NE4210S01)

ABSOLUTE MAXIMUM RATINGS ($T_A = +25^\circ\text{C}$)

Parameter	Symbol	Ratings	Unit
Drain to Source Voltage	V_{DS}	4.0	V
Gate to Source Voltage	V_{GS}	-3.0	V
Drain Current	I_D	I_{DSS}	mA
Gate Current	I_G	100	μA
Total Power Dissipation	P_{tot}	165	mW
Channel Temperature	T_{ch}	125	$^\circ\text{C}$
Storage Temperature	T_{stg}	-65 to +125	$^\circ\text{C}$

RECOMMENDED OPERATING CONDITIONS ($T_A = +25^\circ\text{C}$)

Parameter	Symbol	MIN.	TYP.	MAX.	Unit
★ Drain to Source Voltage	V_{DS}	1	2	3	V
★ Drain Current	I_D	5	10	15	mA
Input Power	P_{in}	-	-	0	dBm

The information in this document is subject to change without notice. Before using this document, please confirm that this is the latest version.
Not all devices/types available in every country. Please check with local NEC representative for availability and additional information.

ELECTRICAL CHARACTERISTICS (T_A = +25 °C)

Parameter	Symbol	Test Conditions	MIN.	TYP.	MAX.	Unit
Gate to Source Leak Current	I _{GSO}	V _{GS} = -3 V	-	0.5	10	μA
Saturated Drain Current	I _{DSS}	V _{DS} = 2 V, V _{GS} = 0 V	15	40	70	mA
Gate to Source Cut off Voltage	V _{GS (off)}	V _{DS} = 2 V, I _{DS} = 100 μA	-0.2	-0.7	-2.0	V
Transconductance	g _m	V _{DS} = 2 V, I _{DS} = 10 mA	40	55	-	mS
Noise Figure	NF	V _{DS} = 2 V, I _{DS} = 10 mA	-	0.50	0.70	dB
Associated Gain	G _a	f = 12 GHz	11.0	13.0	-	dB

TYPICAL CHARACTERISTICS ($T_A = +25\text{ }^\circ\text{C}$)

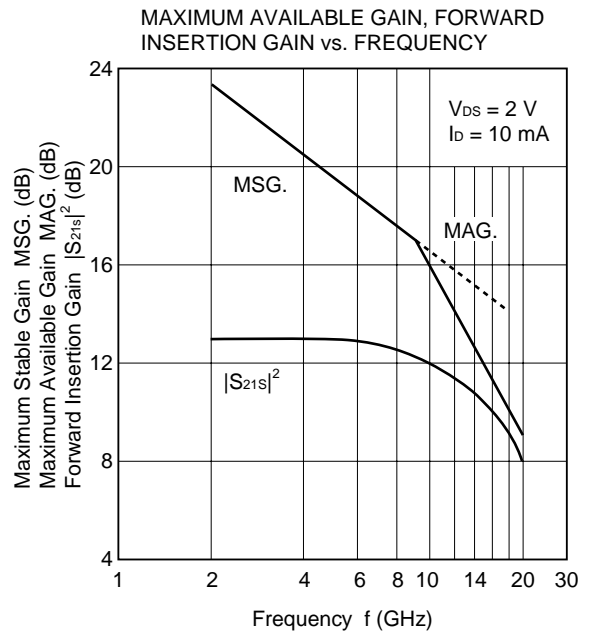
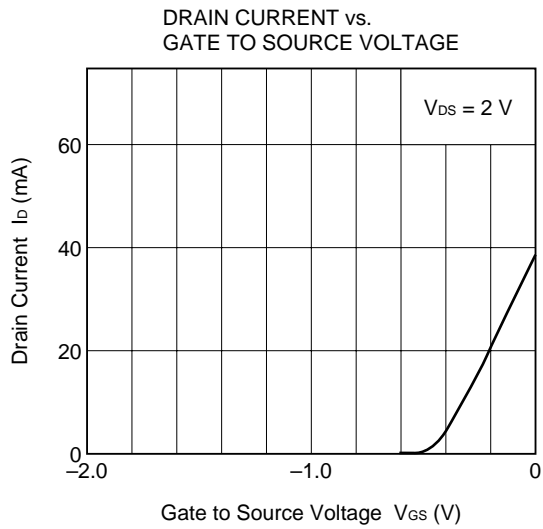
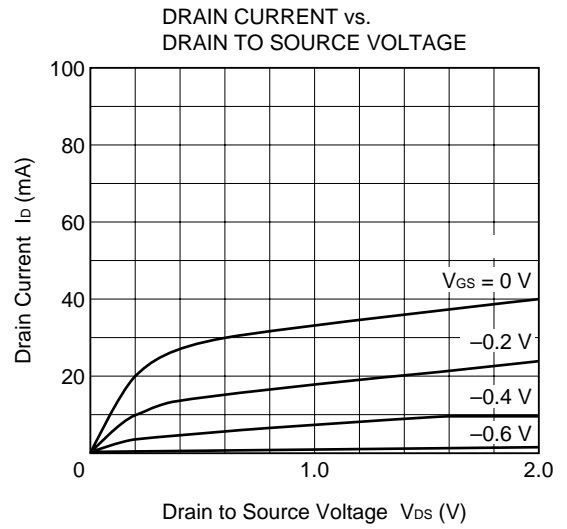
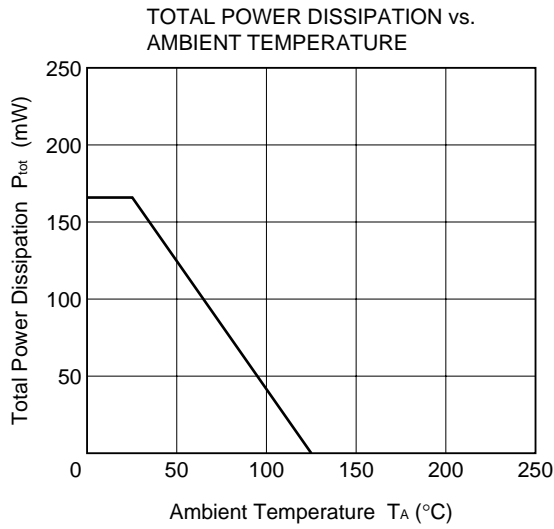

Gain Calculations

$$MSG. = \left| \frac{S_{21}}{S_{12}} \right| \quad K = \frac{1 + |\Delta|^2 - |S_{11}|^2 - |S_{22}|^2}{2 |S_{12}| |S_{21}|}$$

$$MAG. = \left| \frac{S_{21}}{S_{12}} \right| (k \pm \sqrt{k^2 - 1}) \quad \Delta = S_{11} \cdot S_{22} - S_{21} \cdot S_{12}$$

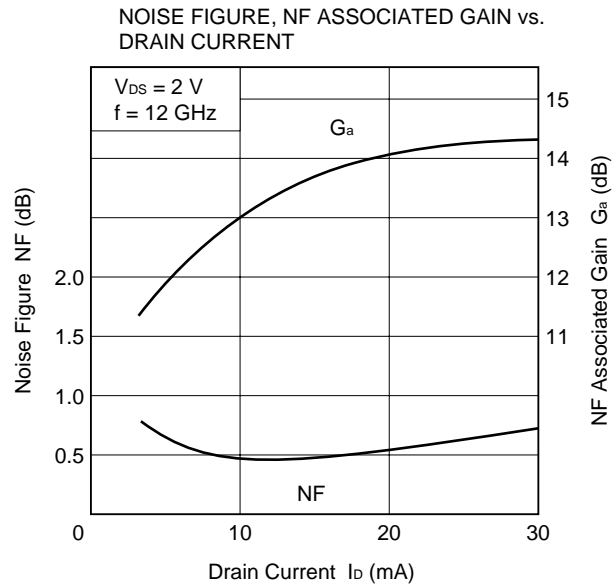
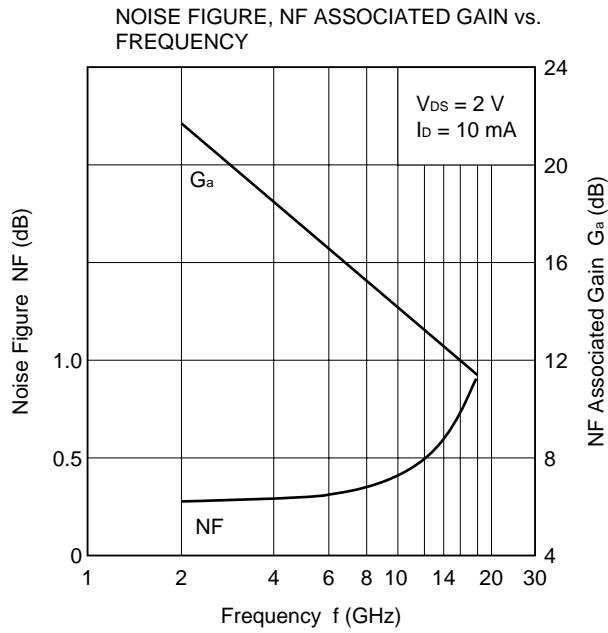

S-PARAMETERS
MAG. AND ANG.

V_{DS} = 2 V, I_D = 10 mA

FREQUENCY MHz	S ₁₁		S ₂₁		S ₁₂		S ₂₂	
	MAG.	ANG.	MAG.	ANG.	MAG.	ANG.	MAG.	ANG.
2000.0000	0.972	-21.0	4.436	153.9	0.026	73.8	0.621	-16.6
2500.0000	0.953	-27.3	4.435	147.1	0.033	69.6	0.610	-21.6
3000.0000	0.934	-34.1	4.443	139.9	0.039	63.7	0.592	-27.1
3500.0000	0.910	-40.2	4.385	132.9	0.044	60.0	0.579	-32.2
4000.0000	0.887	-45.8	4.306	126.3	0.047	54.4	0.564	-37.2
4500.0000	0.865	-51.1	4.244	120.0	0.051	50.2	0.554	-41.6
5000.0000	0.842	-55.5	4.164	114.1	0.054	46.6	0.546	-45.5
5500.0000	0.821	-60.0	4.129	108.3	0.057	42.8	0.538	-49.4
6000.0000	0.802	-64.8	4.122	102.6	0.061	40.6	0.531	-52.1
6500.0000	0.777	-70.2	4.151	96.5	0.067	37.6	0.519	-56.5
7000.0000	0.732	-76.4	4.175	89.8	0.071	33.0	0.495	-60.5
7500.0000	0.685	-83.4	4.179	82.9	0.073	28.7	0.460	-63.9
8000.0000	0.652	-91.3	4.184	76.2	0.077	25.6	0.423	-67.5
8500.0000	0.619	-100.8	4.210	69.1	0.082	23.0	0.385	-72.2
9000.0000	0.591	-111.0	4.189	61.5	0.086	18.0	0.344	-78.5
9500.0000	0.563	-120.7	4.131	54.4	0.091	13.4	0.301	-86.2
10000.0000	0.538	-129.7	4.070	47.4	0.094	10.7	0.270	-95.5
10500.0000	0.517	-138.8	4.023	40.3	0.099	6.5	0.250	-107.2
11000.0000	0.488	-148.6	3.963	33.2	0.103	1.7	0.236	-118.7
11500.0000	0.460	-158.9	3.905	26.1	0.104	-2.6	0.225	-127.6
12000.0000	0.433	-171.3	3.850	18.5	0.108	-7.1	0.215	-137.8
12500.0000	0.424	175.5	3.767	10.9	0.111	-11.2	0.194	-147.8
13000.0000	0.421	161.6	3.675	3.3	0.113	-16.9	0.166	-161.6
13500.0000	0.436	147.9	3.551	-4.2	0.112	-19.9	0.144	177.6
14000.0000	0.461	135.9	3.421	-11.5	0.112	-24.6	0.137	151.7
14500.0000	0.495	125.0	3.285	-18.5	0.113	-28.5	0.161	127.6
15000.0000	0.528	115.2	3.151	-25.9	0.111	-32.0	0.210	111.3
15500.0000	0.542	106.7	3.003	-32.3	0.109	-33.5	0.254	104.7
16000.0000	0.556	99.3	2.885	-39.0	0.108	-37.0	0.301	101.1
16500.0000	0.561	91.0	2.764	-46.4	0.107	-39.4	0.347	99.3
17000.0000	0.564	82.6	2.609	-53.3	0.108	-42.3	0.381	96.0
17500.0000	0.571	74.3	2.456	-59.7	0.106	-46.1	0.396	91.6
18000.0000	0.581	67.3	2.297	-65.8	0.103	-48.0	0.400	87.1

AMPLIFIER PARAMETERS

V_{DS} = 2 V, I_D = 10 mA

FREQUENCY MHz	GU _{max} dB	GA _{max} dB	S ₂₁ ² dB	S ₁₂ ² dB	K	Delay ns	Mason's U dB	G1 dB	G2 dB
2000.0000	27.67		12.94	-31.55	0.25	0.038	30.256	12.61	2.12
2500.0000	25.31		12.94	-29.62	0.32	0.038	28.341	10.35	2.02
3000.0000	23.75		12.95	-28.24	0.38	0.040	26.068	8.92	1.87
3500.0000	22.25		12.84	-27.19	0.44	0.039	25.369	7.64	1.77
4000.0000	21.07		12.68	-26.58	0.51	0.037	23.501	6.73	1.66
4500.0000	20.15		12.56	-25.82	0.57	0.035	22.666	6.00	1.59
5000.0000	19.29		12.39	-25.36	0.63	0.033	21.854	5.36	1.54
5500.0000	18.67		12.32	-24.81	0.68	0.032	21.290	4.87	1.48
6000.0000	18.21		12.30	-24.30	0.71	0.032	21.403	4.47	1.44
6500.0000	17.75		12.36	-23.49	0.72	0.034	21.682	4.03	1.37
7000.0000	16.97		12.41	-22.94	0.80	0.037	20.537	3.33	1.22
7500.0000	16.21		12.42	-22.70	0.90	0.038	19.541	2.75	1.04
8000.0000	15.69		12.43	-22.29	0.94	0.037	19.390	2.40	0.85
8500.0000	15.28		12.49	-21.76	0.96	0.040	19.809	2.10	0.70
9000.0000	14.85		12.44	-21.32	0.98	0.042	19.658	1.87	0.55
9500.0000	14.39	16.34	12.32	-20.83	1.00	0.040	19.512	1.65	0.41
10000.0000	14.01	15.53	12.19	-20.53	1.02	0.039	19.822	1.49	0.33
10500.0000	13.72	15.40	12.09	-20.11	1.01	0.040	20.318	1.35	0.28
11000.0000	13.39	14.90	11.96	-19.74	1.02	0.039	20.322	1.18	0.25
11500.0000	13.09	14.27	11.83	-19.67	1.06	0.039	19.926	1.03	0.22
12000.0000	12.81	13.92	11.71	-19.33	1.07	0.042	20.054	0.90	0.21
12500.0000	12.54	13.56	11.52	-19.11	1.08	0.042	20.125	0.86	0.17
13000.0000	12.28	13.16	11.31	-18.97	1.11	0.042	19.648	0.85	0.12
13500.0000	12.02	12.78	11.01	-19.05	1.14	0.042	19.328	0.92	0.09
14000.0000	11.80	12.51	10.68	-19.03	1.15	0.041	19.111	1.04	0.08
14500.0000	11.66	12.38	10.33	-18.96	1.14	0.039	19.447	1.22	0.11
15000.0000	11.58	12.32	9.97	-19.10	1.13	0.041	19.785	1.42	0.20
15500.0000	11.35	12.01	9.55	-19.25	1.16	0.036	19.151	1.51	0.29
16000.0000	11.22	11.95	9.20	-19.33	1.15	0.037	19.274	1.60	0.41
16500.0000	11.03	11.80	8.83	-19.41	1.15	0.041	18.894	1.64	0.56
17000.0000	10.67	11.40	8.33	-19.37	1.16	0.039	17.879	1.66	0.68
17500.0000	10.26	10.86	7.81	-19.46	1.21	0.035	16.470	1.72	0.74
18000.0000	9.77	10.19	7.22	-19.74	1.30	0.034	14.659	1.78	0.76

S-PARAMETERS
MAG. AND ANG.

V_{DS} = 0 V, V_{GS} = 0 V

FREQUENCY MHz	S ₁₁		S ₂₁		S ₁₂		S ₂₂	
	MAG.	ANG.	MAG.	ANG.	MAG.	ANG.	MAG.	ANG.
2000.0000	0.990	-20.7	0.016	109.0	0.016	102.3	0.751	151.4
2500.0000	0.981	-27.1	0.022	103.4	0.020	103.6	0.751	145.4
3000.0000	0.978	-33.8	0.028	103.5	0.028	101.6	0.762	139.8
3500.0000	0.972	-40.2	0.035	102.0	0.033	100.1	0.756	134.2
4000.0000	0.966	-46.4	0.042	98.5	0.041	97.5	0.760	128.8
4500.0000	0.962	-52.4	0.052	96.0	0.050	94.8	0.761	122.4
5000.0000	0.957	-57.6	0.061	91.4	0.059	91.1	0.755	115.8
5500.0000	0.954	-63.3	0.070	88.1	0.070	86.6	0.755	109.2
6000.0000	0.949	-69.1	0.080	83.7	0.080	82.6	0.758	102.2
6500.0000	0.944	-75.8	0.092	77.8	0.092	77.9	0.757	95.4
7000.0000	0.930	-83.5	0.107	73.0	0.105	71.9	0.765	88.8
7500.0000	0.916	-92.8	0.121	66.5	0.120	66.3	0.773	83.4
8000.0000	0.905	-103.2	0.135	59.3	0.133	58.8	0.780	78.7
8500.0000	0.894	-114.6	0.147	51.6	0.146	51.6	0.793	75.3
9000.0000	0.885	-126.2	0.158	45.1	0.158	44.3	0.804	72.4
9500.0000	0.878	-137.1	0.169	38.3	0.168	38.2	0.809	69.6
10000.0000	0.871	-147.7	0.181	32.0	0.179	31.7	0.819	66.7
10500.0000	0.873	-158.2	0.193	25.6	0.192	25.5	0.821	63.6
11000.0000	0.875	-169.7	0.205	17.9	0.205	17.8	0.821	60.4
11500.0000	0.873	178.0	0.218	9.8	0.216	9.9	0.820	55.9
12000.0000	0.863	164.3	0.227	1.5	0.225	1.3	0.819	51.7
12500.0000	0.869	150.7	0.231	-7.0	0.231	-7.6	0.819	46.6
13000.0000	0.868	137.7	0.230	-15.4	0.230	-15.8	0.831	41.8
13500.0000	0.869	126.0	0.225	-22.7	0.226	-24.0	0.841	37.3
14000.0000	0.880	115.8	0.219	-29.7	0.217	-29.3	0.850	34.6
14500.0000	0.892	107.3	0.212	-33.7	0.213	-34.1	0.858	33.2
15000.0000	0.907	98.5	0.207	-39.4	0.206	-39.4	0.866	32.5
15500.0000	0.904	90.7	0.201	-43.9	0.199	-44.0	0.870	32.2
16000.0000	0.905	83.7	0.198	-48.1	0.199	-47.8	0.866	31.7
16500.0000	0.884	75.5	0.194	-53.0	0.191	-52.9	0.863	30.5
17000.0000	0.867	67.7	0.188	-58.1	0.188	-58.0	0.861	28.1
17500.0000	0.846	60.0	0.182	-62.4	0.182	-63.0	0.856	24.5
18000.0000	0.831	54.0	0.172	-67.1	0.174	-67.5	0.850	20.0

AMPLIFIER PARAMETERS

V_{DS} = 0 V, V_{GS} = 0 V

FREQUENCY MHz	GU _{max} dB	GA _{max} dB	S ₂₁ ² dB	S ₁₂ ² dB	K	Delay ns	Mason's U dB	G1 dB	G2 dB
2000.0000	-15.19	-15.16	-36.00	-35.92	16.25	0.031	-33.488	17.21	3.60
2500.0000	-15.56	-15.55	-33.32	-33.83	19.06	0.031	-40.201	14.15	3.61
3000.0000	-13.78	-13.82	-31.18	-31.20	12.08	-0.001	-42.783	13.62	3.78
3500.0000	-12.82	-12.91	-29.06	-29.53	10.34	0.009	-36.658	12.55	3.69
4000.0000	-12.01	-12.15	-27.46	-27.66	8.42	0.019	-42.595	11.71	3.74
4500.0000	-10.64	-10.88	-25.71	-25.99	6.36	0.014	-38.655	11.32	3.75
5000.0000	-9.97	-10.27	-24.36	-24.54	5.48	0.025	-42.970	10.72	3.67
5500.0000	-8.93	-9.35	-23.06	-23.10	4.38	0.018	-39.542	10.47	3.66
6000.0000	-8.16	-8.69	-21.90	-21.98	3.80	0.025	-40.847	10.03	3.71
6500.0000	-7.40	-8.05	-20.76	-20.70	3.25	0.033	-49.494	9.66	3.70
7000.0000	-6.88	-7.62	-19.40	-19.61	3.05	0.027	-36.513	8.69	3.82
7500.0000	-6.50	-7.33	-18.38	-18.39	2.80	0.036	-53.452	7.93	3.94
8000.0000	-5.91	-6.83	-17.42	-17.50	2.54	0.040	-42.015	7.44	4.06
8500.0000	-5.40	-6.42	-16.66	-16.69	2.31	0.043	-52.459	6.96	4.30
9000.0000	-4.90	-6.03	-16.05	-16.02	2.12	0.036	-40.046	6.63	4.52
9500.0000	-4.45	-5.67	-15.46	-15.49	1.99	0.038	-51.895	6.39	4.62
10000.0000	-3.86	-5.22	-14.85	-14.95	1.83	0.035	-40.055	6.17	4.82
10500.0000	-3.21	-4.74	-14.30	-14.32	1.66	0.035	-48.996	6.23	4.86
11000.0000	-2.61	-4.26	-13.78	-13.78	1.52	0.043	-60.695	6.29	4.88
11500.0000	-2.16	-3.92	-13.24	-13.33	1.45	0.045	-39.289	6.23	4.86
12000.0000	-2.13	-3.90	-12.89	-12.97	1.44	0.046	-39.470	5.93	4.83
12500.0000	-1.81	-3.72	-12.74	-12.72	1.39	0.047	-38.276	6.10	4.83
13000.0000	-1.59	-3.62	-12.77	-12.76	1.37	0.047	-42.090	6.07	5.11
13500.0000	-1.50	-3.60	-12.94	-12.93	1.36	0.040	-31.392	6.11	5.34
14000.0000	-1.16	-3.42	-13.19	-13.28	1.33	0.039	-36.132	6.47	5.56
14500.0000	-0.79	-3.27	-13.48	-13.45	1.29	0.022	-40.171	6.90	5.80
15000.0000	-0.19	-2.83	-13.68	-13.74	1.23	0.032	-40.013	7.51	6.01
15500.0000	-0.41	-2.97	-13.93	-14.02	1.25	0.025	-36.170	7.37	6.15
16000.0000	-0.62	-3.10	-14.06	-14.03	1.26	0.024	-40.930	7.42	6.03
16500.0000	-1.71	-3.79	-14.26	-14.37	1.42	0.027	-37.301	6.62	5.94
17000.0000	-2.63	-4.43	-14.53	-14.54	1.57	0.028	-55.485	6.04	5.86
17500.0000	-3.61	-5.16	-14.82	-14.78	1.79	0.024	-40.919	5.47	5.74
18000.0000	-4.60	-5.92	-15.27	-15.19	2.07	0.026	-42.429	5.10	5.57

S-PARAMETERS
MAG. AND ANG.

V_{DS} = 0 V, V_{GS} = -2.5 V

FREQUENCY MHz	S ₁₁		S ₂₁		S ₁₂		S ₂₂	
	MAG.	ANG.	MAG.	ANG.	MAG.	ANG.	MAG.	ANG.
2000.0000	0.994	-12.8	0.040	74.2	0.041	74.9	0.982	-15.4
2500.0000	0.985	-16.9	0.051	69.4	0.050	68.3	0.981	-20.0
3000.0000	0.982	-21.3	0.061	65.3	0.061	64.1	0.976	-24.8
3500.0000	0.976	-25.4	0.070	59.3	0.070	59.2	0.973	-29.7
4000.0000	0.972	-29.2	0.079	54.6	0.079	54.1	0.966	-34.6
4500.0000	0.970	-33.0	0.087	50.3	0.087	49.3	0.965	-39.3
5000.0000	0.968	-36.0	0.095	45.4	0.094	45.1	0.962	-43.5
5500.0000	0.963	-38.8	0.101	41.6	0.102	41.3	0.961	-47.5
6000.0000	0.964	-41.7	0.109	39.3	0.110	38.9	0.957	-50.7
6500.0000	0.960	-44.3	0.121	36.6	0.119	35.6	0.956	-54.8
7000.0000	0.952	-47.2	0.135	31.2	0.134	31.9	0.957	-58.9
7500.0000	0.947	-50.8	0.148	26.5	0.148	26.4	0.949	-63.1
8000.0000	0.941	-55.4	0.161	22.0	0.161	21.5	0.939	-67.5
8500.0000	0.936	-61.1	0.176	16.5	0.176	16.7	0.932	-73.0
9000.0000	0.930	-67.1	0.193	10.4	0.194	10.0	0.923	-79.2
9500.0000	0.922	-73.3	0.208	4.1	0.209	3.6	0.913	-86.8
10000.0000	0.912	-78.7	0.221	-2.8	0.223	-2.8	0.903	-94.9
10500.0000	0.908	-84.2	0.236	-8.8	0.238	-9.3	0.900	-103.4
11000.0000	0.908	-89.3	0.253	-15.8	0.254	-16.1	0.900	-111.7
11500.0000	0.905	-94.9	0.267	-22.0	0.268	-23.0	0.899	-118.7
12000.0000	0.898	-101.4	0.284	-30.3	0.283	-30.7	0.906	-126.7
12500.0000	0.901	-108.7	0.300	-38.0	0.300	-38.8	0.899	-134.6
13000.0000	0.893	-117.4	0.316	-47.4	0.317	-47.8	0.894	-143.1
13500.0000	0.876	-127.1	0.328	-57.2	0.328	-57.8	0.880	-153.0
14000.0000	0.866	-138.2	0.334	-68.3	0.334	-68.9	0.877	-164.1
14500.0000	0.860	-149.8	0.332	-80.4	0.331	-80.9	0.875	-177.7
15000.0000	0.865	-161.4	0.320	-93.4	0.322	-93.4	0.877	168.2
15500.0000	0.866	-172.6	0.298	-104.7	0.298	-105.5	0.880	155.6
16000.0000	0.883	177.5	0.273	-115.0	0.272	-115.5	0.893	144.2
16500.0000	0.888	166.8	0.249	-125.2	0.248	-125.3	0.913	135.1
17000.0000	0.874	153.9	0.226	-135.9	0.223	-136.1	0.924	127.5
17500.0000	0.865	140.6	0.203	-147.2	0.199	-147.2	0.932	120.9
18000.0000	0.839	126.8	0.170	-156.8	0.171	-159.4	0.927	114.0

AMPLIFIER PARAMETERS

V_{DS} = 0 V, V_{GS} = -2.5 V

FREQUENCY MHz	GU _{max} dB	GA _{max} dB	S ₂₁ ² dB	S ₁₂ ² dB	K	Delay ns	Mason's U dB	G1 dB	G2 dB
2000.0000	5.45	-2.13	-27.93	-27.82	1.12	0.026	-28.423	18.97	14.41
2500.0000	3.65	-2.54	-25.89	-25.96	1.18	0.026	-29.391	15.27	14.27
3000.0000	3.32	-2.67	-24.34	-24.23	1.19	0.023	-27.770	14.51	13.16
3500.0000	2.83	-2.75	-23.07	-23.05	1.21	0.033	-49.384	13.23	12.67
4000.0000	2.30	-2.91	-22.10	-22.00	1.23	0.026	-33.498	12.62	11.78
4500.0000	2.73	-2.68	-21.18	-21.19	1.20	0.024	-30.661	12.24	11.67
5000.0000	2.73	-2.61	-20.47	-20.50	1.19	0.027	-39.320	11.96	11.25
5500.0000	2.68	-2.61	-19.91	-19.86	1.18	0.021	-37.388	11.44	11.15
6000.0000	2.93	-2.52	-19.26	-19.20	1.17	0.013	-34.861	11.45	10.75
6500.0000	3.36	-2.26	-18.34	-18.49	1.15	0.015	-26.993	11.02	10.68
7000.0000	3.59	-2.11	-17.41	-17.46	1.12	0.030	-31.857	10.29	10.72
7500.0000	3.29	-2.11	-16.61	-16.62	1.12	0.026	-45.807	9.86	10.05
8000.0000	2.84	-2.21	-15.87	-15.87	1.13	0.025	-35.681	9.43	9.28
8500.0000	2.78	-2.18	-15.09	-15.10	1.13	0.031	-40.714	9.05	8.82
9000.0000	2.69	-2.14	-14.31	-14.26	1.12	0.034	-35.203	8.72	8.28
9500.0000	2.37	-2.23	-13.63	-13.60	1.13	0.035	-35.298	8.24	7.77
10000.0000	2.00	-2.34	-13.10	-13.03	1.14	0.038	-37.411	7.75	7.35
10500.0000	2.23	-2.22	-12.55	-12.47	1.13	0.034	-31.948	7.58	7.20
11000.0000	2.80	-1.90	-11.94	-11.89	1.09	0.039	-36.170	7.54	7.20
11500.0000	3.15	-1.69	-11.47	-11.44	1.08	0.034	-27.602	7.44	7.17
12000.0000	3.69	-1.33	-10.94	-10.97	1.05	0.046	-30.925	7.14	7.48
12500.0000	3.99	-1.10	-10.46	-10.45	1.03	0.043	-25.841	7.27	7.19
13000.0000	3.91	-0.98	-9.99	-9.98	1.03	0.052	-30.075	6.95	6.96
13500.0000	3.12	-1.26	-9.68	-9.68	1.04	0.055	-29.034	6.33	6.47
14000.0000	2.86	-1.36	-9.53	-9.51	1.05	0.061	-29.463	6.01	6.38
14500.0000	2.55	-1.54	-9.58	-9.60	1.06	0.067	-31.274	5.84	6.29
15000.0000	2.47	-1.64	-9.90	-9.85	1.07	0.073	-37.889	5.99	6.38
15500.0000	1.95	-1.97	-10.52	-10.52	1.10	0.062	-29.488	6.01	6.47
16000.0000	2.23	-1.99	-11.28	-11.31	1.11	0.057	-34.340	6.57	6.93
16500.0000	2.46	-1.97	-12.07	-12.11	1.11	0.057	-38.158	6.76	7.78
17000.0000	1.68	-2.33	-12.92	-13.03	1.15	0.059	-32.987	6.27	8.34
17500.0000	0.92	-2.67	-13.87	-14.04	1.21	0.063	-30.080	6.00	8.79
18000.0000	-1.59	-4.11	-15.41	-15.35	1.47	0.054	-26.585	5.28	8.53

NOISE PARAMETERS

V_{DS} = 2 V, I_D = 10 mA

Freq. (GHz)	NF _{min.} (dB)	G _a (dB)	Γ _{opt}		Rn/50
			MAG.	ANG.	
2.0	0.29	20.7	0.94	12	0.38
4.0	0.30	18.7	0.80	26	0.33
6.0	0.33	17.0	0.66	44	0.26
8.0	0.38	15.4	0.50	68	0.18
10.0	0.43	14.1	0.38	97	0.11
12.0	0.50	13.0	0.29	133	0.09
14.0	0.59	12.3	0.27	177	0.08
16.0	0.71	11.8	0.33	-129	0.11
18.0	0.86	11.2	0.39	-82	0.23

TYPICAL MOUNT PAD LAYOUT

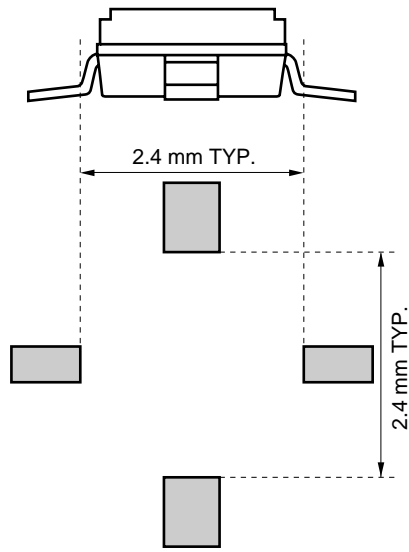

PACKAGE DIMENSIONS (Unit: mm)

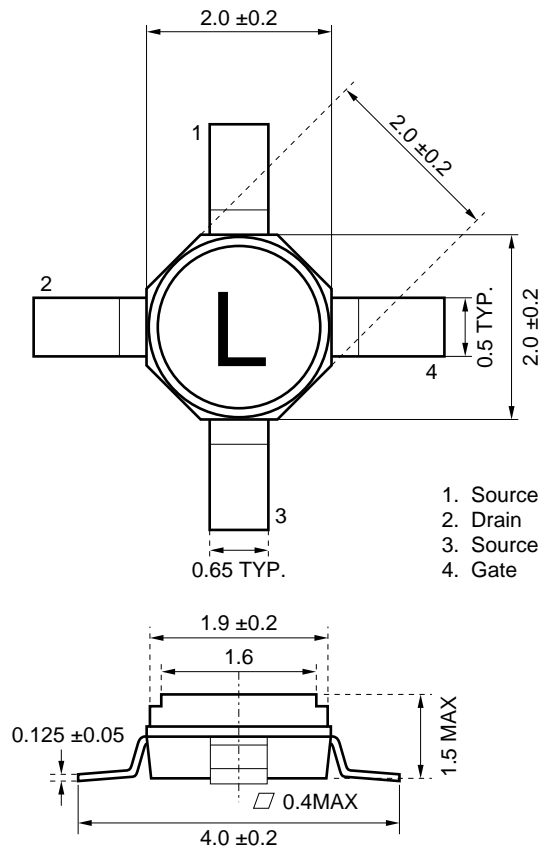

NOTE ON CORRECT USE

- (1) Because this device is a GaAs MES FET with a Schottky barrier gate structure, it is necessary that sufficient care be taken regarding static electricity and strong electric fields.
Take measures against static electricity and make sure the body is earthed when mounting the device.
- (2) Follow the procedure below when operating the device by a gate-and-drain-independent dual power supply.
Directly ground both the source pins.
 V_{GS} = fixed to approximately -4 V.
Increase V_{DS} to a predetermined voltage level (within the recommended operating range of V_{DS}).
Adjust V_{GS} in line with a predetermined I_D .
- (3) It is recommended that the bias application circuit be able to have a fixed voltage and current.
- (4) Adjust the I/O matching circuit after turning the bias OFF.

RECOMMENDED SOLDERING CONDITIONS

This product should be soldered under the following recommended conditions. For soldering methods and conditions other than those recommended below, contact your NEC sales representative.

Soldering Method	Soldering Conditions	Recommended Condition Symbol
Infrared Reflow	Package peak temperature: 230 °C or below Time: 30 seconds or less (at 210 °C) Count: 1, Exposure limit : None ^{Note}	IR30-00-1
Partial Heating	Pin temperature: 230 °C Time: 10 seconds or less (per pin row) Exposure limit : None ^{Note}	—

Note After opening the dry pack, keep it in a place below 25 °C and 65 % RH for the allowable storage period.

Caution Do not use different soldering methods together (except for partial heating).

[MEMO]

CAUTION

The Great Care must be taken in dealing with the devices in this guide.

The reason is that the material of the devices is GaAs (Gallium Arsenide), which is designated as harmful substance according to the law concerned.

Keep the law concerned and so on, especially in case of removal.

- **The information in this document is subject to change without notice. Before using this document, please confirm that this is the latest version.**

- No part of this document may be copied or reproduced in any form or by any means without the prior written consent of NEC Corporation. NEC Corporation assumes no responsibility for any errors which may appear in this document.

- NEC Corporation does not assume any liability for infringement of patents, copyrights or other intellectual property rights of third parties by or arising from use of a device described herein or any other liability arising from use of such device. No license, either express, implied or otherwise, is granted under any patents, copyrights or other intellectual property rights of NEC Corporation or others.

- Descriptions of circuits, software, and other related information in this document are provided for illustrative purposes in semiconductor product operation and application examples. The incorporation of these circuits, software, and information in the design of the customer's equipment shall be done under the full responsibility of the customer. NEC Corporation assumes no responsibility for any losses incurred by the customer or third parties arising from the use of these circuits, software, and information.

- While NEC Corporation has been making continuous effort to enhance the reliability of its semiconductor devices, the possibility of defects cannot be eliminated entirely. To minimize risks of damage or injury to persons or property arising from a defect in an NEC semiconductor device, customers must incorporate sufficient safety measures in its design, such as redundancy, fire-containment, and anti-failure features.

- NEC devices are classified into the following three quality grades:

"Standard", "Special", and "Specific". The Specific quality grade applies only to devices developed based on a customer designated "quality assurance program" for a specific application. The recommended applications of a device depend on its quality grade, as indicated below. Customers must check the quality grade of each device before using it in a particular application.

Standard: Computers, office equipment, communications equipment, test and measurement equipment, audio and visual equipment, home electronic appliances, machine tools, personal electronic equipment and industrial robots

Special: Transportation equipment (automobiles, trains, ships, etc.), traffic control systems, anti-disaster systems, anti-crime systems, safety equipment and medical equipment (not specifically designed for life support)

Specific: Aircraft, aerospace equipment, submersible repeaters, nuclear reactor control systems, life support systems or medical equipment for life support, etc.

The quality grade of NEC devices is "Standard" unless otherwise specified in NEC's Data Sheets or Data Books. If customers intend to use NEC devices for applications other than those specified for Standard quality grade, they should contact an NEC sales representative in advance.

射频和天线设计培训课程推荐

易迪拓培训(www.edatop.com)由数名来自于研发第一线的资深工程师发起成立,致力并专注于微波、射频、天线设计研发人才的培养;我们于 2006 年整合合并微波 EDA 网(www.mweda.com),现已发展成为国内最大的微波射频和天线设计人才培养基地,成功推出多套微波射频以及天线设计经典培训课程和 ADS、HFSS 等专业软件使用培训课程,广受客户好评;并先后与人民邮电出版社、电子工业出版社合作出版了多本专业图书,帮助数万名工程师提升了专业技术能力。客户遍布中兴通讯、研通高频、埃威航电、国人通信等多家国内知名公司,以及台湾工业技术研究院、永业科技、全一电子等多家台湾地区企业。

易迪拓培训课程列表: <http://www.edatop.com/peixun/rfe/129.html>



射频工程师养成培训课程套装

该套装精选了射频专业基础培训课程、射频仿真设计培训课程和射频电路测量培训课程三个类别共 30 门视频培训课程和 3 本图书教材;旨在引领学员全面学习一个射频工程师需要熟悉、理解和掌握的专业知识和研发设计能力。通过套装的学习,能够让学员完全达到和胜任一个合格的射频工程师的要求...

课程网址: <http://www.edatop.com/peixun/rfe/110.html>

ADS 学习培训课程套装

该套装是迄今国内最全面、最权威的 ADS 培训教程,共包含 10 门 ADS 学习培训课程。课程是由具有多年 ADS 使用经验的微波射频与通信系统设计领域资深专家讲解,并多结合设计实例,由浅入深、详细而又全面地讲解了 ADS 在微波射频电路设计、通信系统设计和电磁仿真设计方面的内容。能让您在最短的时间内学会使用 ADS,迅速提升个人技术能力,把 ADS 真正应用到实际研发工作中去,成为 ADS 设计专家...

课程网址: <http://www.edatop.com/peixun/ads/13.html>



HFSS 学习培训课程套装



该套课程套装包含了本站全部 HFSS 培训课程,是迄今国内最全面、最专业的 HFSS 培训教程套装,可以帮助您从零开始,全面深入学习 HFSS 的各项功能和在多个方面的工程应用。购买套装,更可超值赠送 3 个月免费学习答疑,随时解答您学习过程中遇到的棘手问题,让您的 HFSS 学习更加轻松顺畅...

课程网址: <http://www.edatop.com/peixun/hfss/11.html>

CST 学习培训课程套装

该培训套装由易迪拓培训联合微波 EDA 网共同推出,是最全面、系统、专业的 CST 微波工作室培训课程套装,所有课程都由经验丰富的专家授课,视频教学,可以帮助您从零开始,全面系统地学习 CST 微波工作的各项功能及其在微波射频、天线设计等领域的设计应用。且购买该套装,还可超值赠送 3 个月免费学习答疑...

课程网址: <http://www.edatop.com/peixun/cst/24.html>



HFSS 天线设计培训课程套装

套装包含 6 门视频课程和 1 本图书,课程从基础讲起,内容由浅入深,理论介绍和实际操作讲解相结合,全面系统的讲解了 HFSS 天线设计的全过程。是国内最全面、最专业的 HFSS 天线设计课程,可以帮助您快速学习掌握如何使用 HFSS 设计天线,让天线设计不再难...

课程网址: <http://www.edatop.com/peixun/hfss/122.html>

13.56MHz NFC/RFID 线圈天线设计培训课程套装

套装包含 4 门视频培训课程,培训将 13.56MHz 线圈天线设计原理和仿真设计实践相结合,全面系统地讲解了 13.56MHz 线圈天线的工作原理、设计方法、设计考量以及使用 HFSS 和 CST 仿真分析线圈天线的具体操作,同时还介绍了 13.56MHz 线圈天线匹配电路的设计和调试。通过该套课程的学习,可以帮助您快速学习掌握 13.56MHz 线圈天线及其匹配电路的原理、设计和调试...

详情浏览: <http://www.edatop.com/peixun/antenna/116.html>



我们的课程优势:

- ※ 成立于 2004 年,10 多年丰富的行业经验,
- ※ 一直致力并专注于微波射频和天线设计工程师的培养,更了解该行业对人才的要求
- ※ 经验丰富的一线资深工程师讲授,结合实际工程案例,直观、实用、易学

联系我们:

- ※ 易迪拓培训官网: <http://www.edatop.com>
- ※ 微波 EDA 网: <http://www.mweda.com>
- ※ 官方淘宝店: <http://shop36920890.taobao.com>